

leggett & platt®

fashion home™

6755 W. 65th Bedford Park, IL 60638

Parts List For Bar Stool # C1X080

BAR STOOL CARTON

- (6) LEFT SIDE PANEL-1
- (7) RIGHT SIDE PANEL-1
- (8) FOOT REST METAL FRAME-1
- (9) SEAT-1
- (10) BACK PANEL-1

HARDWARE BAG # 391802

- (1) 1/4-20 X 3/4" FLAT ALLEN HEAD SCREW-12
- (2) 1/4" ID METAL SPRING WASHER-12
- (3) 1/4" ID X 5/8" OD FLAT METAL WASHER-12
- (4) 1/4-20 X 7/8" FLAT ALLEN HEAD SOCKET NUT-6
- (5) ALLEN WRENCH-2

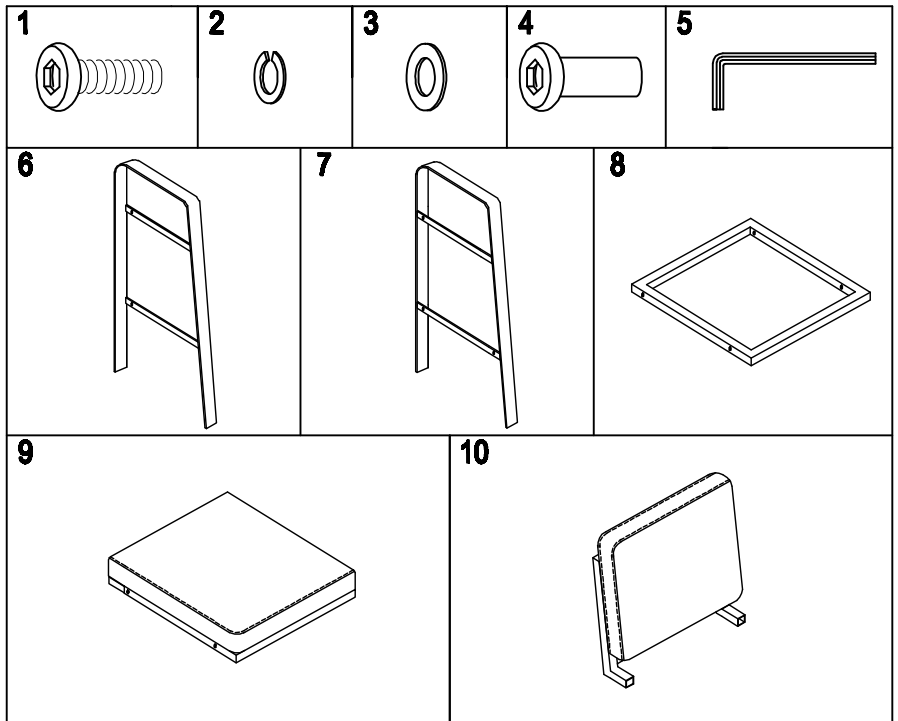

SAVE ALL PACKAGING MATERIALS UNTIL PRODUCT IS FULLY ASSEMBLED. HARDWARE AND SMALL PIECES MAY NOT BE SEEN AND COULD BE ACCIDENTALLY DISCARDED WITH PACKAGING MATERIALS.

PRODUCT FULLY ASSEMBLED

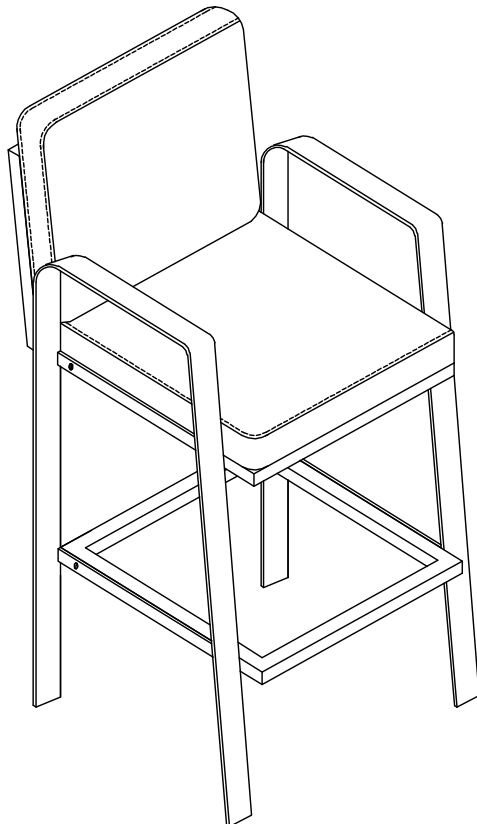

FOR ASSISTANCE IN ASSEMBLY ONLY OF THIS PRODUCT. CALL OUR HELP DESK AT 1-800-324-3415, BETWEEN 8:30 AM & 4:30 PM CENTRAL TIME MONDAY THRU FRIDAY. PLEASE HAVE THE STYLE NUMBER AVAILABLE BEFORE YOU CALL. (STYLE # OR NAME CAN BE FOUND ON PACKING CARTON OR SALES RECEIPT.) OUR PRODUCT IS INSPECTED TO ENSURE IT IS IN GOOD CONDITION. IF YOUR FURNITURE APPEARS TO HAVE BEEN DAMAGED IN SHIPMENT OR YOU ARE IN NEED OF REPLACEMENT PARTS PLEASE CONTACT THE DEALER FROM WHOM YOU PURCHASED THE PRODUCT.

# Instruction Sheet

## STEP 1- Assembly of Side Panels to Foot Rest Metal Frame.

- Align pilot holes on left side panel (6) metal rail with holes on foot rest metal frame (8). SEE FIGURE 1
- Secure foot rest metal frame (8) with screw (1),spring washer (2),flat metal washer (3) and flat Allen head socket nut (4).Finger tighten screws. DO NOT TIGHTEN SCREWS COMPLETELY
- Repeat for right side panel (7).

## STEP 2- Assembly of Seat to Side Panels.

- Align pilot holes on side panels (6 & 7) metal rail with front holes on seat (9). SEE FIGURE 2
- Secure seat (9) with screw (1),spring washer (2),flat metal washer (3) and flat Allen head socket nut (4).Finger tighten screws. DO NOT TIGHTEN SCREWS COMPLETELY
- Align pilot holes on side panel (6 & 7) metal rail with threaded holes on seat (9). SEE FIGURE 2
- Secure seat (9) with screw (1),spring washer (2),flat metal washer (3).  
Finger tighten screws. DO NOT TIGHTEN SCREWS COMPLETELY

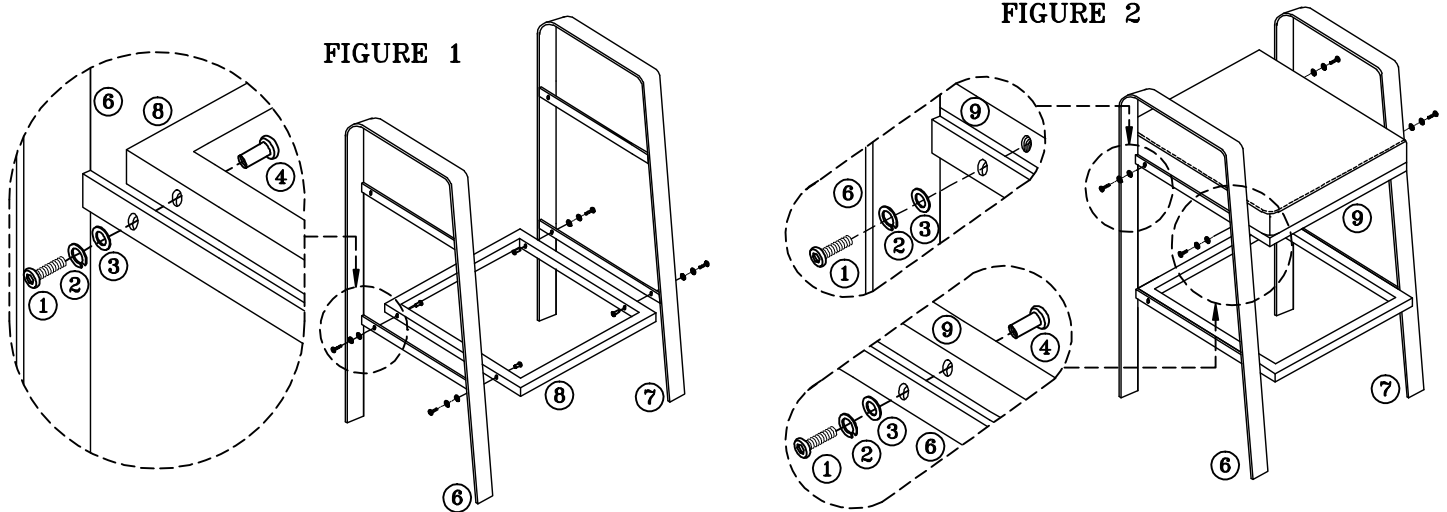

## STEP 3- Assembly of Back Panel to Seat.

- Align reduction on seat (9) with metal tube on back panel (10). SEE FIGURE 3
- Carefully insert reduction into metal tube and secure with screw (1), spring washer (2) and flat metal washer (3) into bottom holes on seat (9).
- Tighten screw completely with both Allen wrench (4).
- NOW TIGHTEN ALL SCREWS (1) FROM STEPS 1 AND 2 (FIGURE 1-2)

