

leggett & platt®

fashion home™

6755 W. 65th Street Bedford Park, IL 60638

Parts List For Bar Stool # C1M000

BAR STOOL CARTON

- (9) BOTTOM METAL RING-1
- (10) BOTTOM LEG PANEL-1
- (11) TOP LEG PANEL-1
- (12) FOOT REST METAL RING-1
- (13) SEAT-1

PART #391402 HARDWARE BAG

- (1) 8MM X 13MM FLAT ALLEN HEAD SOCKET NUT-4
- (2) 8MM X 10MM ROUND ALLEN HEAD SCREW-4
- (3) 1/4-20 X 5/8" FLAT ALLEN HEAD SCREW-8
- (4) 1/4" ID METAL SPRING WASHER-12
- (5) 1/4" ID X 5/8" OD FLAT METAL WASHER-12
- (6) 1/4-20 X 1 1/2" FLAT ALLEN HEAD SCREW-4
- (7) 5MM ALLEN WRENCH-2
- (8) 4MM ALLEN WRENCH-1

- (14) PLASTIC GLIDE -4 #391403

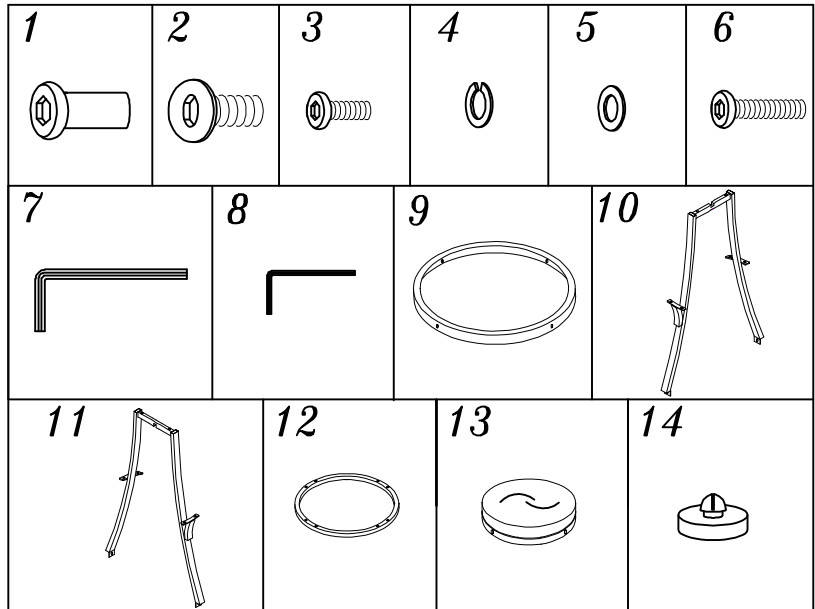

SAVE ALL PACKAGING MATERIALS UNTIL PRODUCT IS FULLY ASSEMBLED. HARDWARE AND SMALL PIECES MAY NOT BE SEEN AND COULD BE ACCIDENTALLY DISCARDED WITH PACKAGING MATERIALS.

PRODUCT FULLY ASSEMBLED

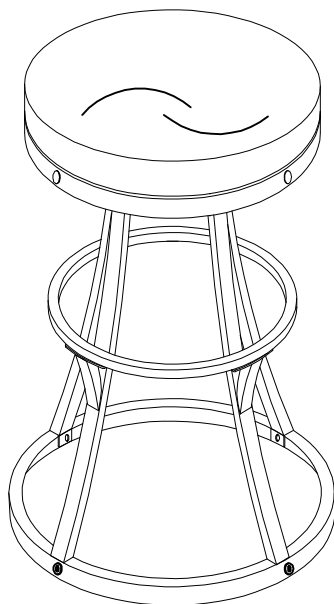

FOR ASSISTANCE IN ASSEMBLY ONLY OF THIS PRODUCT, CALL OUR HELP DESK AT 1-800-324-3415, BETWEEN 8:30 AM & 4:30 PM CENTRAL TIME MONDAY THROUGH FRIDAY. PLEASE HAVE THE STYLE NUMBER AVAILABLE BEFORE YOU CALL. (STYLE # OR NAME CAN BE FOUND ON PACKING CARTON OR SALES RECEIPT.) OUR PRODUCT IS INSPECTED TO ENSURE IT IS IN GOOD CONDITION. IF YOUR FURNITURE APPEARS TO HAVE BEEN DAMAGED IN SHIPMENT OR YOU ARE IN NEED OF REPLACEMENT PARTS PLEASE CONTACT THE DEALER FROM WHOM YOU PURCHASED THE PRODUCT.

Instruction Sheet

Step 1- Assembly of Legs Panels to Bottom Metal Ring.

- Insert plastic glide (14) into pilot holes on bottom metal ring (9). SEE FIGURE 1
- Align holes on bottom leg panel (10) metal bracket with pilot holes on bottom metal ring (9). SEE FIGURE 1
- Secure bottom leg panel (10) to bottom metal ring (9) with flat Allen head socket nut (1) and round Allen head screw (2). Use both Allen wrench (7).
- Place top leg panel (11) over bottom leg panel (10) and secure with flat Allen head socket screw (1) and round Allen head screw (2). DO NOT TIGHT SCREWS COMPLETELY

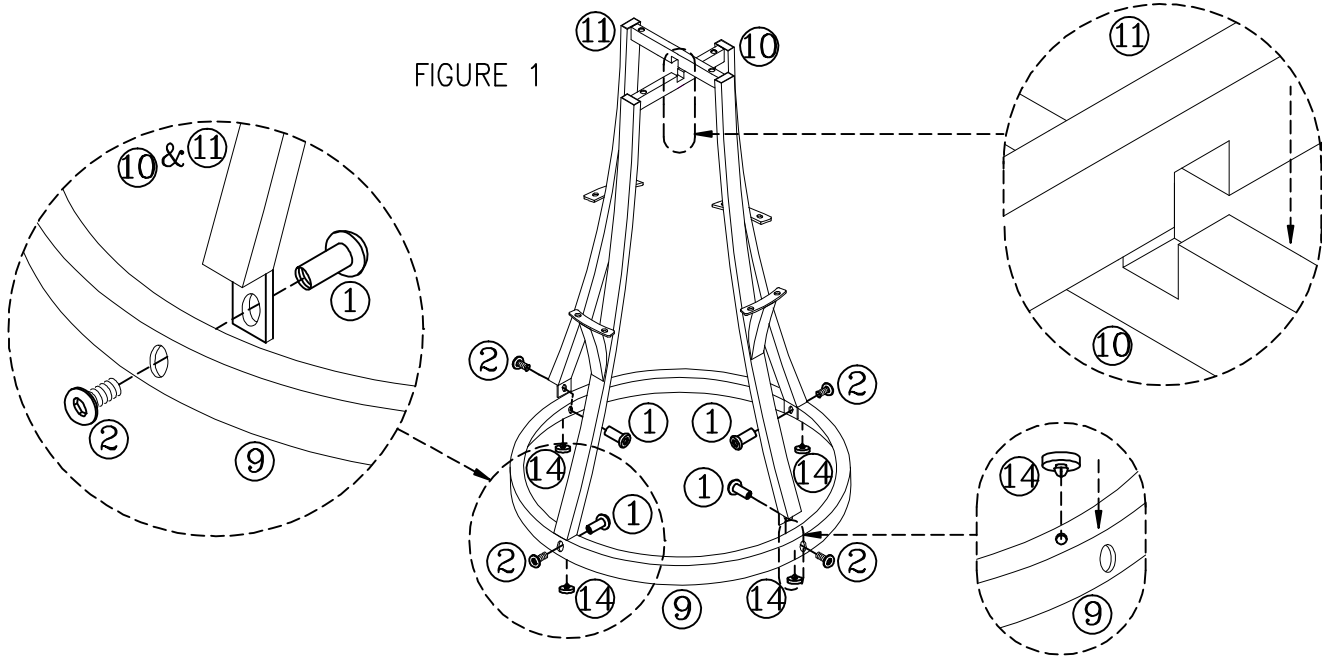

Step 2- Assembly of Foot Rest Metal Ring.

- Place foot rest metal ring (12) over legs panels (10 & 11), align threaded holes on foot rest metal ring (12) with holes on legs metal bracket. Secure foot rest metal ring (12) into legs panel (10 & 11) with screw (3), spring washer (4) and flat metal washer (5). Tighten screws with Allen wrench (8). SEE FIGURE 2
DO NOT TIGHT SCREWS COMPLETELY

Step 3- Assembly of Legs Panel to Seat.

- Align pilot holes on bottom leg panel (10) and top leg panel (11) with threaded holes on swivel plate. SEE FIGURE 3
 - Secure legs panel (10 & 11) with screw (6), metal spring washer (4) and flat metal washer (5). Tighten screws with Allen wrench (8).
- NOW TIGHTEN SCREWS (2) COMPLETELY FROM STEP 1 (FIGURE 1) AND SCREWS (3) FROM STEP 2 (FIGURE 2)

